

# INTERSECTIONAL TREATMENT (TYPE IVb)

(TWO-LANE HIGHWAY)

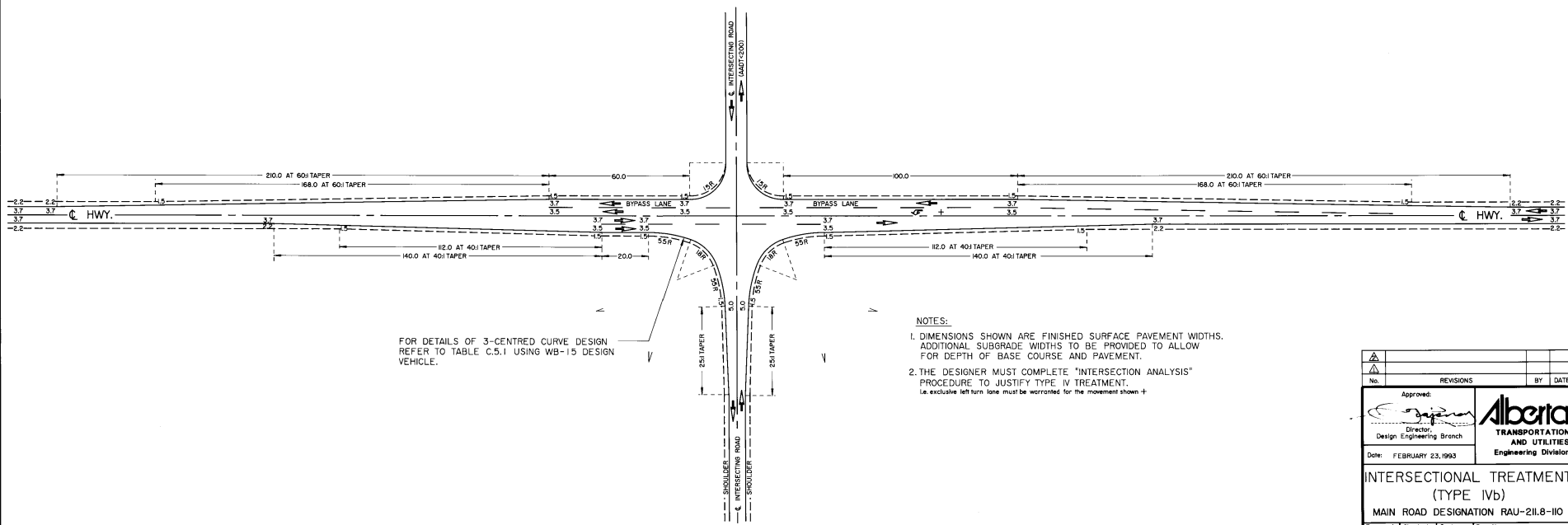

FOR DETAILS OF 3-CENTRED CURVE DESIGN REFER TO TABLE C.5.1 USING WB-15 DESIGN VEHICLE.

- NOTES:**
1. DIMENSIONS SHOWN ARE FINISHED SURFACE PAVEMENT WIDTHS. ADDITIONAL SUBGRADE WIDTHS TO BE PROVIDED TO ALLOW FOR DEPTH OF BASE COURSE AND PAVEMENT.
  2. THE DESIGNER MUST COMPLETE "INTERSECTION ANALYSIS" PROCEDURE TO JUSTIFY TYPE IV TREATMENT. i.e. exclusive left turn lane must be warranted for the movement shown +

▲					
▲	No.	REVISIONS	BY	DATE	
Approved:					
Director Design Engineering Branch			Alberta TRANSPORTATION AND UTILITIES Engineering Division		
Date: FEBRUARY 23, 1993					
INTERSECTIONAL TREATMENT (TYPE IVb)					
MAIN ROAD DESIGNATION RAU-211.8-110					
Prepared By:	RT	Checked By:	N.T.S.	Scale:	Dwg No.: CB6-2.3C32B

ADDRESS: FILE NUMBER: RAU211.8-110