

# Landscape Analysis Tool (LAT) Report

Surface Material Exploration Licence

0000061F6A

Page 1 of 14

<b>LAT Number:</b>	0000061F6A	<b>LAT Date:</b>	2024-05-27	11:35:20
<b>Project Name:</b>	50407506_AreaAandB			
<b>Project Description:</b>				
<b>Disposition Type:</b>	SME	Surface Material Exploration Licence		
<b>Purpose Type:</b>	SRMT	Surface Materials		
<b>Activity Type:</b>	SRMT14SMEP	Exploration - Aggregate		

## Responsibility of Applicants:

It is the applicant's responsibility to conduct a full review of the generated LAT Report, ensuring that you are aware and have a full understanding of the identified standards and conditions, and any additional limitations that may also be imposed by an approved higher level plan, reservation or notation or any other law or Order of the Province or the Government of Canada that may impact the placement, construction or operation of the proposed disposition, purpose and activity.

The applicant must assess if the proposed disposition, purpose and activity can meet the applicable standards, conditions and any limitations which will subsequently determine if the application can be submitted to the regulatory body. Applicants should complete a thorough review of regulatory and application processes including supporting procedural documents and the generated LAT Reports prior to making this determination.

Where the applicant chooses not to meet, or is not able to meet, one or more Approval Standards or higher level plans within the generated LAT Report as submitted as part of the application, or any affected reservations as identified within the land status report, the applicant is required to complete the appropriate mitigation as part of their supplement submission that addresses individually each of the items not being met.

The information provided within the LAT Tool is a spatial representation of features provided to the applicant for activity and land use planning. The accuracy of these layers varies depending on the resource value being represented. The regulatory body insists that site visits, wildlife surveys and groundtruthing efforts are completed to ensure that you, the applicant can meet the procedures detailed within the *Pre-Application Requirements for Formal Dispositions*, the identified approval standards, operating conditions and *Best Management Practices* as represented within the *Master Schedule of Standards and Conditions*.

## Proximity to Watercourse/Waterbodies:

Applicants will ensure that standards or conditions for Watercourse/Waterbody features as identified within the generated LAT Report are followed. It is the responsibility of the applicant to ensure the identified setbacks and buffers are properly established through a pre-site assessment and maintained.

**NOTE:** Be aware that the submission of a LAT Report as part of an application submission does not imply approval of the activity. The standards and conditions identified within the LAT Report may be subject to change based on regulatory review.

# Landscape Analysis Tool (LAT) Report

Surface Material Exploration Licence

0000061F6A

Page 2 of 14

## Base Features

Green/White Area	Green Area
Municipality	M.D. of Lesser Slave River No. 124
FMA	Tolko Industries Ltd., Vanderwell Contractors (1971) Ltd. and West Fraser Mills Ltd. (Slave Lake)
FMU	S17
Provincial Grazing Reserve	
Rocky Mountain Forest Reserve	
PLUZ Areas	
Protected Areas	

## Provincial Sanctuaries

Wildlife Corridors	
Restricted Area	
Game Bird	Zone 1
Seasonal	

# Landscape Analysis Tool (LAT) Report

Surface Material Exploration Licence

0000061F6A

Page 3 of 14

## Higher Level Plans

Integrated Resource Plan (Local)	
Integrated Resource Plan (Subregional)	
Access Management Plan	
Landscape Management Plan	

# Landscape Analysis Tool (LAT) Report

Surface Material Exploration Licence

0000061F6A

Page 4 of 14

## Reservation Listing

Reservation #	Holder Name	Purpose	Reason	Contact Information
CLR230350	EDMONTON OFFICE - OPERATIONS DIVISION, DEPT OF ESRD	Resource Potential	Surface Material	Pamela Hill, 7804152222, Pamela.Hill@gov.ab.ca Joanne Sweeney, 7804271011, Joanne.Sweeney@gov.ab.ca Jane Fletcher, 7804154672, Jane.Fletcher@gov.ab.ca

**Note:**

\* Information displayed in these tables is only a summary of Crown Land Reservation (CLR) information as intersected within the "Reservation - Active" data layer.

\* For more detailed information regarding reservation intent, an applicant can reference this information as contained within the "Reservation - Active" data layer

For more information, please review the Land Use Reservation Program Procedures Guide for guidance on how Crown land Reservations are addressed when applying for an activity on Alberta's Crown lands.

# Landscape Analysis Tool (LAT) Report

---

Surface Material Exploration Licence

0000061F6A

Page 5 of 14

## Reservation ToDos

---

Action	Reservation #	Application Requirement

# Landscape Analysis Tool (LAT) Report

Surface Material Exploration Licence

0000061F6A

Page 6 of 14

## Additional Application Requirements

Wildlife Survey		DND Area	
-----------------	--	----------	--

## Historical Resources

HRV Rating	Category
------------	----------

Historic Resources Application Required: No

While no specific historic resource concerns have been identified within the proposed activity area, Section 31 of the *Historical Resources Act* states that “a person who discovers a historic resource in the course of making an excavation for a purpose other than for the purpose of seeking historic resources shall forthwith notify the Minister of the discovery.” Should a historic resource be encountered with the construction or operation of this disposition, information on who to contact can be found on the Ministry of Culture and Tourism’s website in; Standard Requirements under the Historical Resources Act: Reporting the Discovery of Historic Resources.

# Landscape Analysis Tool (LAT) Report

Surface Material Exploration Licence

0000061F6A

Page 7 of 14

## Sensitive Features

### Wildlife and Other Sensitive Species

	Intersected		Intersected
Burrowing Owl Range		Key Wildlife and Biodiversity Areas	
Caribou Range	Yes	Mountain Goat and Sheep Areas Disease Buffer	
Caribou Range - Zone A			
Caribou Range - Zone B	Yes	Mountain Goat and Sheep Zone	
Colonial Nesting Birds		Ord's Kangaroo Rat Range	
Critical Habitat of Aquatic Species at Risk		Ord's Kangaroo Rat Key Habitat Area	
Endangered and Threatened Plants Ranges		Piping Plover Waterbodies	
Greater Short-horned Lizard Habitat		Provincial Hibernacula Buffer	
Greater Short-horned Lizard Range		Sensitive Amphibian Ranges	
Greater Sage Grouse Core Area		Sensitive Raptor Range	
Greater Sage Grouse Recovery Area		Sensitive Snake Habitat	
Greater Sage Grouse Leks and Buffer		Sensitive Snake Hibernacula Range	
Grizzly Bear Core Access Management Area		Sharp-tailed Grouse Leks and Buffer	
Grizzly Bear Habitat Linkage		Sharp-tailed Grouse Survey	
Grizzly Bear Secondary Access Management Area		Special Access Area	
Grizzly Bear Support Zone	Yes	Swift Fox Range	
High Risk Watersheds		Trumpeter Swan Waterbodies/Watercourse	
		Trumpeter Swan Watercourse Buffer	

### Federal Orders:

	Intersected
Greater Sage Grouse	

### Grassland and Natural Regions:

	Intersected		Intersected
Central Parkland		Mixed Grass Sub-region layer	
Central Parkland and Northern Fescue		Montane	
Chinook Grasslands		Northern Fescue	
Dry Mixed Grass		Peace River Parkland	
Foothills Fescue		Permafrost	
Foothills Parkland Grasslands		Rough Fescue PNT	
Grassland and Parkland Natural Region		Subalpine or Alpine	

# Landscape Analysis Tool (LAT) Report

---

Surface Material Exploration Licence

0000061F6A

Page 8 of 14

## Alberta Township System (ATS) Land List

---

Quarter	Section	Township	Range	Meridian	Road Allow.	Sensitive Features Identified
NW	6	75	4	5		Caribou Range, Green / White Area, Caribou Range - Zone B, Grizzly Bear Support Zone
SW	6	75	4	5		Caribou Range, Green / White Area, Caribou Range - Zone B, Grizzly Bear Support Zone
SE	6	75	4	5		Caribou Range, Green / White Area, Caribou Range - Zone B, Grizzly Bear Support Zone
NE	6	75	4	5		Caribou Range, Green / White Area, Caribou Range - Zone B, Grizzly Bear Support Zone



# Landscape Analysis Tool (LAT) Report

Surface Material Exploration Licence

0000061F6A

Page 9 of 14

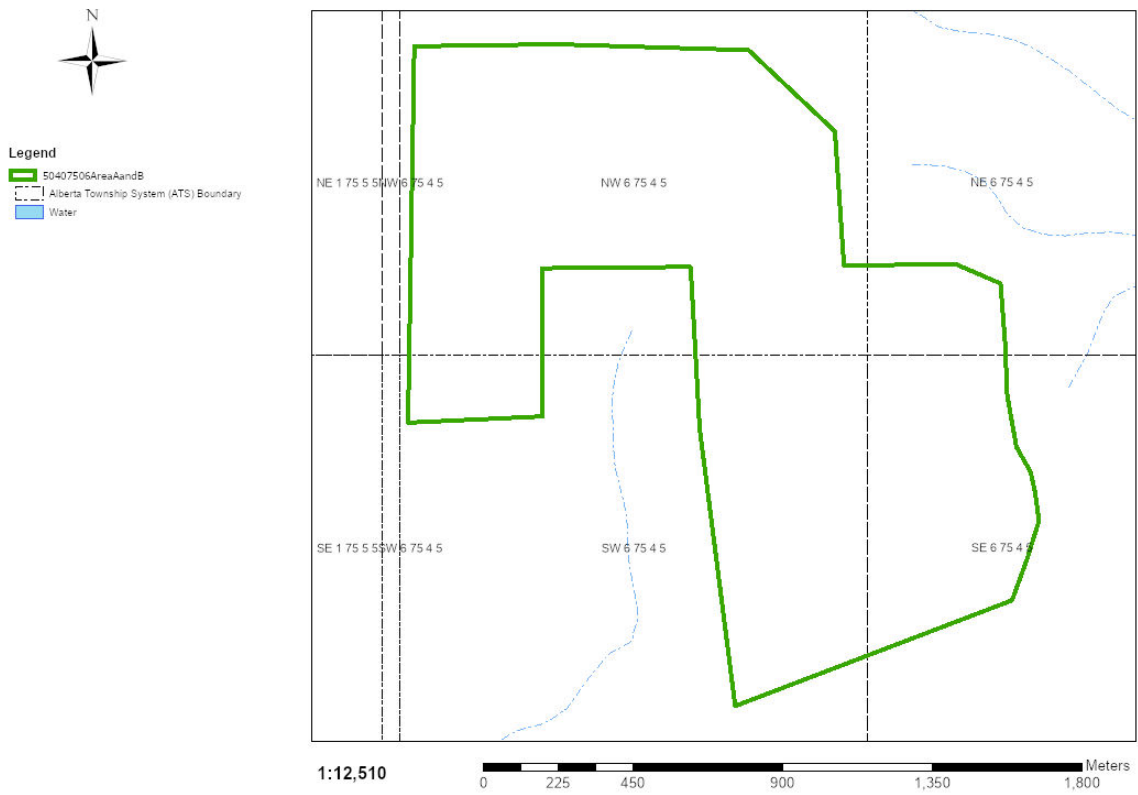

# Landscape Analysis Tool (LAT) Report

Surface Material Exploration Licence

0000061F6A

Page 10 of 14

Land Management		
Report ID	Approval	Condition
1	1030-AS	Where a higher level plan* or reservation identifies a greater set back, the greater set back will prevail.
2	1031-AS	Where a Higher Level Plan* exists, the Disposition Holder must follow any direction provided within that plan.
3	1033-AS	With the exception of pipelines, for activities that fall within any reservation with a purpose code of Fish and Wildlife Resources and encompassing a section of land (259 hectares) or less, located in the Provincial White Area, the Disposition Holder must construct all activities within lands previously disturbed or cleared. Where no previous disturbance exists, activities must occur within 100 metres of the reservation perimeter.
4	1040	The Disposition Holder must repair or replace any improvements immediately that were damaged as a result of the Activity on the Lands to pre-existing dispositions to the pre-existing condition. Damages to tame pastures must be repaired within one growing season.
5	1041	The Disposition Holder must maintain proper drainage of surface water.
6	1044-AS	The Disposition Holder must not locate activities within 45 metres from the top of any coulees* with the exception of activities such as; access, pipelines and linear easements crossing those features.
7	1049	The Disposition Holder must remove all garbage and waste material from this site.
8	1053	The Disposition Holder must not enter the boundaries of any research or sample plot unless consent is received from the reservation holder.
9	1054-AS	When proposed activities cross designated or recreation trail(s)* or when operations encroach on those trail(s)*, the Disposition Holder must ensure that: a. activities crossing trails* are constructed in a manner that will not remove snow from the trail(s)*, produce ruts in the trail(s)*, or otherwise adversely affect travel; b. no mechanical equipment is permitted to travel along the trail(s)* and; c. warning signs are posted along trail(s)* during construction and reclamation activities advising trail* users of the upcoming crossing location.
10	1061	Where FireSmart activities are considered, the Disposition Holder must follow Information Letter- "Authorization of FireSmart Activities on Public Land" as amended from time to time.
11	1115	Within 30 days of completion, the Disposition Holder must provide the Regulatory Body a notification package that includes: a. The date the activity commenced, b. The date the activity concluded c. A listing of the test pit numbers and corresponding GPS locations, and d. A map showing accurate locations of the numbered test pit locations and access used to them.
12	1118	The Disposition Holder must inform the Regulatory Body immediately at the completion of the Activity or upon abandonment of the Lands.

# Landscape Analysis Tool (LAT) Report

Surface Material Exploration Licence

0000061F6A

Page 11 of 14

13	1120	The Disposition Holder must backfill all excavated test holes created with a backhoe (soil horizons replaced in the order that the horizons were found during excavation), compacted and capped.
14	1121	The Disposition Holder must salvage and replace the topsoil/surface soil layer on the surface of the backfilled excavation.

## Vegetation

Report ID	Approval	Condition
15	1300	The disposition holder must manage all regulated weeds to the satisfaction of the regulatory body.
16	1302	The Disposition Holder must remove all deciduous or coniferous merchantable timber from the Activity as per the following utilization standards; <ul style="list-style-type: none"> <li>- Deciduous Timber: 15 cm Base/10 cm Top</li> <li>- Coniferous Timber: 15 cm Base/11cm Top</li> </ul> and haul said timber to the location of end use.
17	1304	For fire control purposes on forested lands, the Disposition Holder must dispose of excess coarse woody debris* not utilized for rollback* or stockpiled for reclamation*.
18	1305	Within FireSmart Community Zones*, the Disposition Holder must dispose of coarse woody debris* by burning unless a Debris Management Plan has been approved under the Forest and Prairie Protection Act.

## Soil

Report ID	Approval	Condition
19	1356	The Disposition Holder must not conduct the Activity during adverse ground conditions*.
20	1357	The Disposition Holder must prevent erosion* and sedimentation on to adjacent* Lands or Water bodies * that results from the activity.
21	1359-AS	The Disposition Holder must not remove from the Lands topsoil* or subsoil* unless approved in writing by the Regulatory Body.
22	1360	Where activities have occurred on the Lands that do not involve minimal disturbance* construction, the Disposition Holder must salvage topsoil* for land reclamation as follows: <ul style="list-style-type: none"> <li>a. Salvage all topsoil* from: <ul style="list-style-type: none"> <li>i. Mineral soils</li> <li>ii. Shallow organic soils*</li> <li>iii. Reclaimed soils</li> </ul> </li> <li>b. Where the depth of the topsoil* is less than 15 cm, the topsoil* and part of the subsoil* to a total depth of 15 centimetres must be salvaged, unless the upper subsoil* is considered chemically unsuitable*.</li> </ul>
23	1363	All reclamation material* must be considered suitable as defined in the May 2001 Salt Contamination Assessment Guidelines and meet the February 2016 Alberta Tier 1 Soil and Groundwater Remediation Guidelines, as amended or replaced from time to time.

# Landscape Analysis Tool (LAT) Report

Surface Material Exploration Licence

0000061F6A

Page 12 of 14

24	1367	The Disposition Holder must not mix wood chips with any reclamation material*.
25	1368	The Disposition Holder must not apply wood chips to the lands at a depth greater than five (5) centimeters.
26	1369	The Disposition Holder must manage wood chips in accordance with the directive ID 2009-01 Management of Wood Chips on Public Land as amended from time to time.
27	1370	The Disposition Holder must not store piles or windrows of reclamation material* within standing timber.
28	1371	The Disposition Holder must not use soil sterilant on the Lands.

## Watercourse / Waterbody

Report ID	Approval	Condition
29	1400-AS	The Disposition Holder is prohibited from conducting activities on islands and the bed and shore* of all water bodies*.
30	1402-AS	The Disposition Holder must not conduct the Activity* within the following water body* setbacks. a) intermittent watercourses* including springs must have a setback of at least 45 metres from the top of the breaks. b) Small permanent watercourses* must have a setback of at least 45 metres from the top of the breaks. c) large permanent watercourses* must have a setback of at least 100 metres from the top of the breaks. d) semi-permanent and permanent ponds, shallow open water ponds and lakes must have setback of 100 metres from the bed and shore*.
31	1412	The Disposition Holder must acquire an authorization for access (off-disposition) for water withdrawal activities.
32	1419	For use of equipment within the bed of a water body*, the Disposition Holder must prior to operations follow the "Decontamination Protocol for Work in or Near Water", as amended from time to time.
33	1420	The Disposition Holder must provide a completed Record of Decontamination form as proof of decontamination to the Regulatory Body upon request.

## Reclamation

Report ID	Approval	Condition
34	1453	The Disposition Holder must complete temporary reclamation* on the Lands within 1 growing season of construction phase* for all topsoil* and subsoil* stockpiles required for final reclamation*.

# Landscape Analysis Tool (LAT) Report

Surface Material Exploration Licence

0000061F6A

Page 13 of 14

35	1454	The Disposition Holder must prior to seeding herbaceous seed in forested* or peatlands* submit a Request for Seeding in writing to the Regulatory Body that contains all of the following: a. rationale for conducting seeding of herbaceous species*; b. a description of the proposed site for seeding including information with respect to the following: i. whether the Lands are subject to high erosion* and; ii. whether the Lands are prone to invasion from agronomic or weed species. c. a proposed seed mix composition for re-vegetation of the Lands in accordance with the Native Plant Revegetation Guidelines for Alberta, 2001 as amended or replaced from time to time or a rationale for alternate species; d. provide a seed certificate in accordance with the Seed Act for the seed mixed mix to be used for re-vegetation* and; any other information requested by the Regulatory Body.
36	1455	The Disposition Holder must only conduct seeding in accordance with the written authorization of the Regulatory Body.
37	1456	The Disposition Holder must when seeding cultivated lands*; a. use agronomic or forage seed that meets or exceeds Certified #1 as outlined in the Seeds Act and Seeds Regulations; b. use seed mixes that are free of species listed in the Weed Control Act and; c. provide a seed certificate to the Regulatory Body within 30 days of request.
38	1457	Within the Green Area* of the Province, the Disposition Holder must re-vegetate the Lands with trees or shrubs that meet the requirements of the December 2016 Alberta Forest Genetic Resource Management and Conservation Standards document, as amended or replaced from time to time.
39	1463	For final reclamation*, the Disposition Holder must complete all of the following: a. contour the disturbed land to the pre-disturbance landform or to the landform approved by the Regulatory body; b. replace all stockpiled subsoil*, then replace all stockpiled topsoil*; c. spread all coarse woody debris* on forested lands* and; d. reclamation materials* must be replaced over the entire area from which they were removed unless otherwise approved in writing by the Regulatory Body.
40	1464	The Disposition Holder must reclaim the Lands to the pre-disturbance land use type* unless otherwise authorized in writing by the Regulatory Body.

## Wildlife

Report ID	Approval	Condition
41	1600	The Disposition Holder must conduct a complete and immediate Wildlife Sweep* of the Lands subject to the disposition prior to any activity, as per the "Wildlife Sweep Protocol".

# Landscape Analysis Tool (LAT) Report

Surface Material Exploration Licence

0000061F6A

Page 14 of 14

42	1601	The Disposition Holder must submit observations from a Wildlife Sweep* to the Fisheries and Wildlife Management Information System (FWMIS) and notify the issuing Regulatory Body in writing upon request that the Wildlife Sweep* was completed.
43	1602-AS	The Disposition Holder must incorporate a buffer* zone of a minimum width of 100m undisturbed vegetation, where an established buffer* does not already exist for any and all key habitat features including, but not limited to leks*, nests, dens and houses identified in the Wildlife Sweep*.
44	1603	When Wildlife Surveys* are required, the Disposition Holder must submit results as defined by the sensitive species inventory guidelines from Wildlife Survey* to the Fisheries and Wildlife Management Information System (FWMIS).
45	1608	The Disposition Holder must incorporate buffers*, setbacks and activity timing restrictions for any and all key habitat features including, but not limited to leks*, nests, dens and houses identified in the wildlife survey*.

## Caribou Range

Report ID	Approval	Condition
46	1905	The Disposition Holder must not seed legumes.
47	1910-AS	The Disposition Holder must not conduct any activities on any of the lands within caribou range between February 15th and July 15th, with the following exceptions: a. all activities with a boundary of the development occurring within 100 metres of an existing arterial all-weather road* can occur at any time (including after February 15th) provided adverse ground conditions* are not encountered and; b. all activities accessed using Class IV or V roads can occur at any time (including after February 15th) provided adverse ground conditions* are not encountered.
48	1911-AS	The Disposition Holder must construct so that a boundary of the development is within 1000 metres of an existing arterial all-weather road* unless otherwise approved under a Regional Access Management Plan.

## Grizzly Bear

Report ID	Approval	Condition
49	1936	The Disposition Holder must re-vegetate activities, associated facilities and clearings to vegetative species compatible and consistent with the adjacent vegetation type.