

WORKSPACE LEGEND:

ELECTRICAL/VOICE/DATA LEGEND (TYPICAL):

⊕ DUPLEX OUTLET

▲ VOICE/DATA

⊗ POWER FEED

NOTE:

1. PROVIDE ALL NECESSARY ELECTRICAL AND POWER HARNESSES/CABLING REQUIRED.
2. IN paneled workspaces, locate electrical in base. provide cable management.

PANELS:

PANELS SHALL BE COMPRISED OF 1 (ONE) MANUFACTURER'S STANDARD HEIGHT BASE PANEL AND 1 (ONE) LOAD BEARING STACKED PANEL TO ACHIEVE AN OVERALL HEIGHT OF 54"± (1372 mm±) TO 60"(1524mm).

PANEL WIDTHS SHALL BE 24" (610mm) , 30" (762mm), OR 42" (1067mm) AS REQUIRED TO ACHIEVE THE OVERALL LAYOUT.

NOTE:

DRAWINGS TO BE READ IN CONJUNCTION WITH TECHNICAL DESIGN REQUIREMENTS (TDR).

TOP PANEL TO BE CLEAR GLASS ON CORRIDOR SIDE. IF ADJACENT TO A HIGH TRAFFIC AREA, GLASS MAY BE FROSTED OR OBSCURED.

ANY DISCREPANCIES SHALL BE BROUGHT TO THE ATTENTION OF TECHNICAL SERVICES.

	CONSULTANT	PROJECT	DRAWN BY	CHECKED BY	SCALE
	DOCUMENT CODE	TITLE	DATE	SITE ID	BUILDING ID
WORKSPACE FURNITURE TYPICALS_APPENDIX I_2022-TDR.V7	TECHNICAL DESIGN REQUIREMENTS VERSION 7	TYPICAL WORKSPACE- LEGEND AND NOTES	2022-08-02	-	-
			PLAN NO.	PHASE	DISCIPLINE
			-	-	-
			PROJECT ID.	SHEET NO.	
			Appendix I	A	

WORKSPACE KIT-OF-PARTS LEGEND:

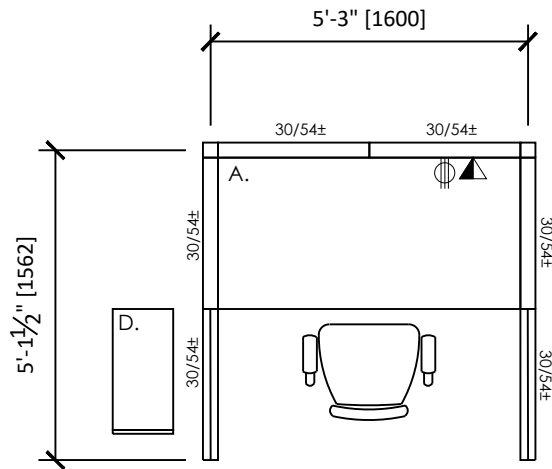

1 HOTELING WORKSPACE
2.5 m²

WORKSTATION FINISHES:

WORKSURFACE TOPS: H.P. PLASTIC LAMINATE C/W STANDARD MATCHING EDGE
LAMINATE: STANDARD GRADE (INCLUDES WOODGRAIN LAMINATE OPTIONS)
LEGS/BASE: STANDARD PAINTED METAL FINISH (INCLUDES METALLIC OPTIONS)

STORAGE TOWER: LAMINATE OR STANDARD PAINTED METAL FINISH
STANDARD PULL (ADA COMPLIANT)

PANEL FINISHES:

CLEAR OR FROSTED SINGLE PANE GLASS - FRAMELESS (ACRYLIC IS NOT ACCEPTABLE)
PANEL FABRIC: GRADE 2/B FABRIC
TOP, END & CORNER TRIMS: FULL-LENGTH, STANDARD PAINTED METAL FINISH (INCLUDES METALLIC OPTIONS)

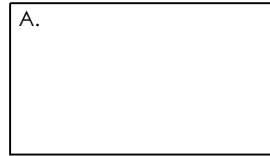

A. PRIMARY WORKSURFACE

- 30" D x 60" W (762 mm D x 1372 mm W)
- PIN HEIGHT ADJUSTABLE LEGS
- CABLE MANAGEMENT ALONG BACK

D. STORAGE TOWER

- 12" W x 24" D x 54" ± H (305 mm W x 610 mm D x 1372 mm ± H)
- COAT ROD INCLUDED
- ANTI-TIP
- SIMILAR OVERALL HEIGHT AS STACKED PANEL
- LOCATE OUTSIDE OF WORKSPACE

GENERAL NOTES

1. REFER TO LEGEND SHEET A, AND SECTION 3 OF THE TECHNICAL DESIGN REQUIREMENTS.
2. TYPICAL PANEL THICKNESS IS 3" ± (76 mm ±) AS PER MANUFACTURER'S STANDARD.
3. AS COMMON PANELS ARE SHARED WHEN THEY ARE GANGED TOGETHER, THE AREA FOR AN INDIVIDUAL WORKSPACE IS BASED ON THE CENTERLINE OF THE PANEL.
4. WORKSURFACES AND STORAGE SHALL HAVE DIMENSIONAL LOGIC AND CONSISTENCY.
5. ALL WORKSURFACES TO BE FREE-STANDING (NON-PANEL HUNG).
6. CHAIRS ARE SHOWN FOR ILLUSTRATION ONLY.

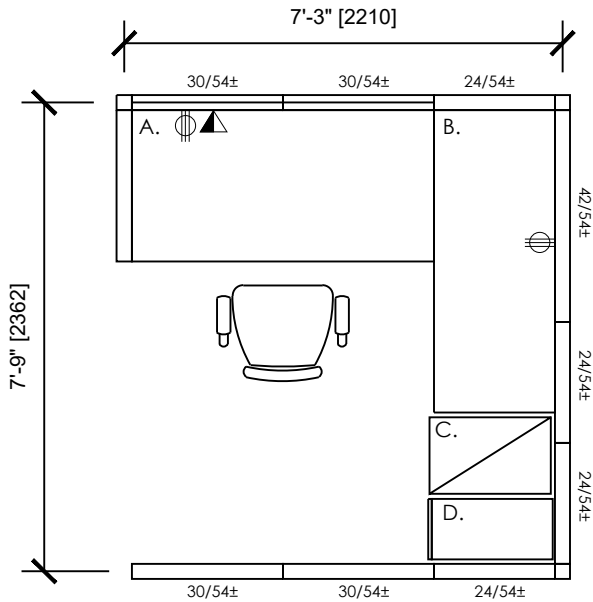

2 ROVER WORKSPACE
5.2 m²

WORKSTATION FINISHES:

WORKSURFACE TOPS: H.P. PLASTIC LAMINATE C/W STANDARD MATCHING EDGE

LAMINATE: STANDARD GRADE (INCLUDES WOOD GRAIN LAMINATE OPTIONS)

LEGS/BASE: STANDARD PAINTED METAL FINISH (INCLUDES METALLIC OPTIONS)

MOBILE BOX, FILE PEDESTAL w/ CUSHION TOP:

CUSHION TOP: GRADE 2/B FABRIC

BODY: STANDARD PAINTED METAL FINISH

STANDARD PULLS (ADA COMPLIANT)

STORAGE TOWER: LAMINATE OR STANDARD PAINTED METAL FINISH

STANDARD PULL (ADA COMPLIANT)

PANEL FINISHES:

CLEAR OR FROSTED SINGLE PANE GLASS - FRAMELESS (ACRYLIC IS NOT ACCEPTABLE)

PANEL FABRIC: GRADE 2/B FABRIC

TOP, END & CORNER TRIMS: FULL-LENGTH, STANDARD PAINTED METAL FINISH (INCLUDES METALLIC OPTIONS)

WORKSPACE KIT-OF-PARTS LEGEND:

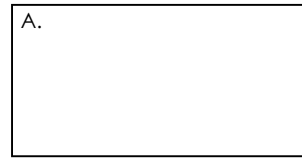

A. PRIMARY WORKSURFACE

- 30" D x 60" W (762 mm D x 1524 mm W)
- ELECTRIC OR PNEUMATIC HEIGHT ADJUSTABLE
- CABLE MANAGEMENT ALONG BACK

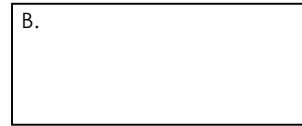

B. SECONDARY WORKSURFACE

- 24" D x 60" W (610 mm D x 1524 mm W)
- PIN HEIGHT ADJUSTABLE POST LEGS (C-LEGS OPTIONAL)
- CABLE MANAGEMENT ALONG BACK

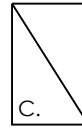

C. MOBILE PEDESTAL w/ CUSHION TOP

- 18"-24" D (450mm x 610 mm D)
- BOX/FILE DRAWERS c/w DIVIDERS, LEGAL/LETTER FILE HANGING BARS, PENCIL TRAY



D. STORAGE TOWER

- 12" W x 24" D x 54"± H (305 mm W x 610 mm D x 1372 mm ± H)
- COAT ROD INCLUDED
- ANTI-TIP
- SIMILAR OVERALL HEIGHT AS STACKED PANEL

GENERAL NOTES

1. REFER TO LEGEND SHEET A, AND SECTION 3 OF THE TECHNICAL DESIGN REQUIREMENTS.
2. TYPICAL PANEL THICKNESS IS 3"± (76 mm ±) AS PER MANUFACTURER'S STANDARD.
3. AS COMMON PANELS ARE SHARED WHEN THEY ARE GANGED TOGETHER, THE AREA FOR AN INDIVIDUAL WORKSPACE IS BASED ON THE CENTERLINE OF THE PANEL.
4. WORKSURFACES AND STORAGE SHALL HAVE DIMENSIONAL LOGIC AND CONSISTENCY.
5. ALL WORKSURFACES TO BE FREE-STANDING (NON-PANEL HUNG).
6. ALL STORAGE TO BE LOCKABLE AND KEYED ALIKE.
7. CHAIRS ARE SHOWN FOR ILLUSTRATION ONLY.



CONSULTANT	PROJECT
DOCUMENT CODE	TITLE
WORKSPACE FURNITURE TYPICALS_APPENDIX I_2022-TDR.V7	TYPICAL WORKSPACE- ROVER

TECHNICAL DESIGN REQUIREMENTS VERSION 7	DRAWN BY JH	CHECKED BY LJ	SCALE NTS
	DATE 2022-08-02	SITE ID -	BUILDING ID -
	PLAN NO. -	PHASE -	DISCIPLINE -
	PROJECT ID. Appendix I	SHEET NO. 2	

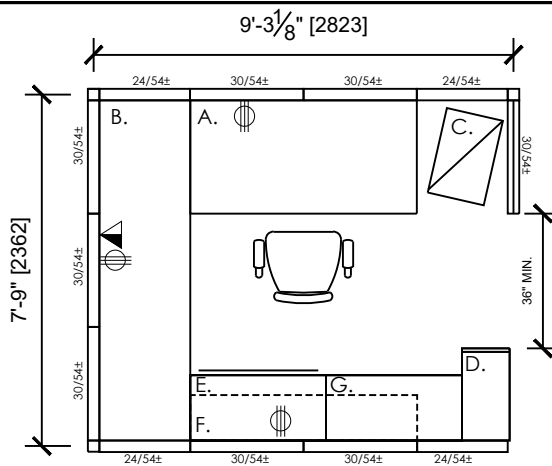

3 RESIDENT WORKSPACE
6.7 m²

WORKSTATION FINISHES:

WORKSURFACE TOPS: H.P. PLASTIC LAMINATE C/W STANDARD MATCHING EDGE

LAMINATE: STANDARD GRADE (INCLUDES WOODGRAIN LAMINATE OPTIONS)

LEGS/BASE: STANDARD PAINTED METAL FINISH (INCLUDES METALLIC OPTIONS)

MOBILE BOX, FILE PEDESTAL w/ CUSHION TOP:

CUSHION TOP: GRADE 2/B FABRIC

BODY: STANDARD PAINTED METAL FINISH

STANDARD PULLS (ADA COMPLIANT)

STORAGE TOWER: LAMINATE OR STANDARD PAINTED METAL FINISH

STANDARD PULL (ADA COMPLIANT)

LOW STORAGE:

LAMINATE OR STANDARD PAINTED METAL FINISH

STANDARD PULL (ADA COMPLIANT)

OPEN SHELF:

STANDARD PAINTED METAL FINISH

WORKSPACE KIT-OF-PARTS LEGEND:

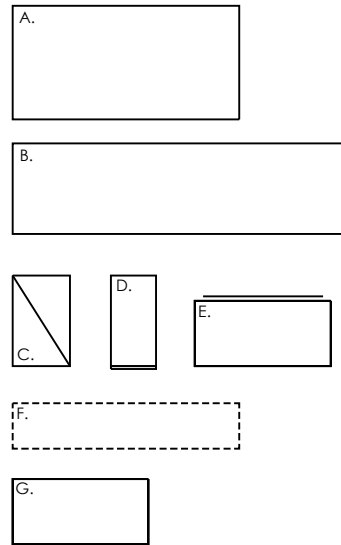

PANEL FINISHES:

CLEAR OR FROSTED SINGLE PANE GLASS - FRAMELESS (ACRYLIC IS NOT ACCEPTABLE)

PANEL FABRIC: GRADE 2/B FABRIC

TOP, END & CORNER TRIMS: FULL LENGTH, STANDARD PAINTED METAL FINISH (INCLUDES METALLIC OPTIONS)

GENERAL NOTES

1. REFER TO LEGEND SHEET A, AND SECTION 3 OF THE TECHNICAL DESIGN REQUIREMENTS.
2. TYPICAL PANEL THICKNESS IS 3"± (76 mm ±) AS PER MANUFACTURER'S STANDARD.
3. AS COMMON PANELS ARE SHARED WHEN THEY ARE GANGED TOGETHER, THE AREA FOR AN INDIVIDUAL WORKSPACE IS BASED ON THE CENTRELINE OF THE PANEL.
4. WORKSURFACES AND STORAGE SHALL HAVE DIMENSIONAL LOGIC AND CONSISTENCY.
5. ALL WORKSURFACES TO BE FREE-STANDING (NON-PANEL HUNG).
6. ALL STORAGE TO BE LOCKABLE AND KEYED ALIKE.
7. COMPONENTS LISTED AS OPTIONAL CAN BE MIXED AND MATCHED, OR OMITTED.
8. CHAIRS ARE SHOWN FOR ILLUSTRATION ONLY.

A. PRIMARY WORKSURFACE

- 30" D x 60" W (762 mm D x 1524 mm W)
- ELECTRIC OR PNEUMATIC HEIGHT ADJUSTABLE
- CABLE MANAGEMENT ALONG BACK

B. SECONDARY WORKSURFACE

- 24" D x 90" W (610 mm D x 2286 mm W)
- PIN HEIGHT ADJUSTABLE POST LEGS (C-LEGS OPTIONAL)
- CABLE MANAGEMENT ALONG BACK

C. MOBILE PEDESTAL w/ CUSHION TOP

- 18"-24" D (450mm x 610 mm D)
- BOX/FILE DRAWERS c/w DIVIDERS, LEGAL/LETTER FILE HANGING BARS, PENCIL TRAY

D. STORAGE TOWER

- 12" W x 24" D x 54"± H (305 mm W x 610 mm D x 1372 mm ± H)
- COAT ROD INCLUDED
- ANTI-TIP
- SIMILAR OVERALL HEIGHT AS STACKED PANEL

E. LOW FILE STORAGE (OPTIONAL)

- 36" W x 18" D x 27"± H (914 mm W x 457 mm D x 686 mm ± H)
- 2 DRAWER LATERAL c/w DIVIDERS, LEGAL/LETTER FILE HANGING BARS
- FLUSH BACK AND FINISHED TOP
- ANTI-TIP

F. OPEN SHELF (OPTIONAL)

- 60" W (1524 mm W)
- UNDERMOUNT TASK LIGHT (OPTIONAL)

G. LOW OPEN STORAGE (OPTIONAL)

- 36" W x 18" D x 27"± H (914 mm W x 457 mm D x 686 mm ± H)
- ONE SHELF
- FLUSH BACK AND FINISHED TOP



CONSULTANT	
DOCUMENT CODE	WORKSPACE FURNITURE TYPICALS_APPENDIX I_2022-TDR.V7

PROJECT	TECHNICAL DESIGN REQUIREMENTS VERSION 7
TITLE	TYPICAL WORKSPACE- RESIDENT

DRAWN BY	JH	CHECKED BY	LJ	SCALE	NTS
DATE	2022-08-02	SITE ID	-	BUILDING ID	-
PLAN NO.	-	PHASE	-	DISCIPLINE	-
PROJECT ID.	Appendix I	SHEET NO.	3		

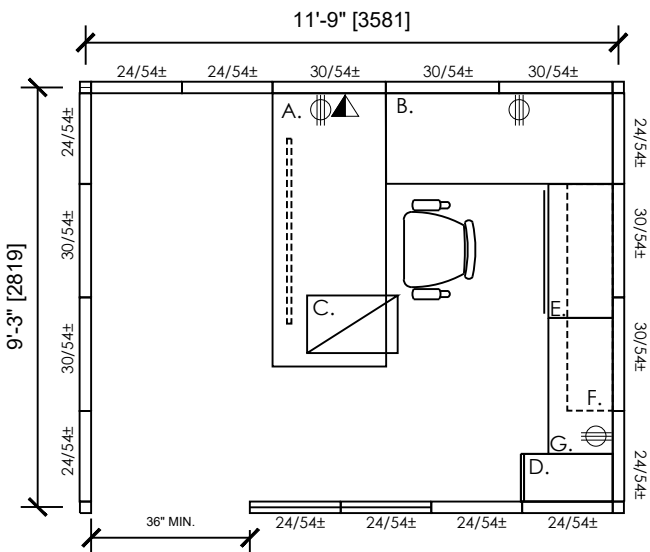

4 DIRECTOR (AND EQUIVALENT) WORKSPACE
10.1 m²

WORKSTATION FINISHES:

WORKSURFACE TOPS: H.P. PLASTIC LAMINATE C/W STANDARD MATCHING EDGE

LAMINATE: STANDARD GRADE (INCLUDES WOODGRAIN LAMINATE OPTIONS)

LEGS/BASE: STANDARD PAINTED METAL FINISH (INCLUDES METALLIC OPTIONS)

MOBILE BOX, FILE PEDESTAL w/ CUSHION TOP:

CUSHION TOP: GRADE 2/B FABRIC

BODY: STANDARD PAINTED METAL FINISH

STANDARD PULLS (ADA COMPLIANT)

STORAGE TOWER: LAMINATE OR STANDARD PAINTED METAL FINISH

STANDARD PULL (ADA COMPLIANT)

LOW STORAGE: LAMINATE OR STANDARD PAINTED METAL FINISH

STANDARD PULL (ADA COMPLIANT)

OPEN SHELF:

STANDARD PAINTED METAL FINISH

PANEL FINISHES:

CLEAR OR FROSTED SINGLE PANE GLASS - FRAMELESS (ACRYLIC IS NOT ACCEPTABLE)

PANEL FABRIC: GRADE 2/B FABRIC

END, TOP, & CORNER TRIMS: FULL LENGTH, STANDARD PAINTED METAL FINISH (INCLUDES METALLIC OPTIONS)

WORKSPACE KIT-OF-PARTS LEGEND:

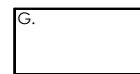
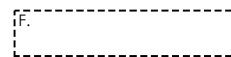
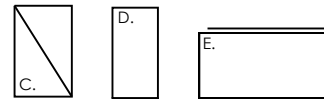
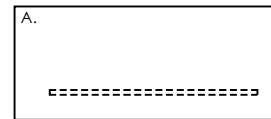

A. PRIMARY WORKSURFACE

- 30" D x 72" W (762 mm D x 1829 mm W)
- ELECTRIC OR PNEUMATIC HEIGHT ADJUSTABLE
- HALF HEIGHT MODESTY PANEL
- CABLE MANAGEMENT ALONG SIDE

B. SECONDARY WORKSURFACE

- 24" D x 60" W (610 mm D x 1524 mm W)
- PIN HEIGHT ADJUSTABLE POST LEGS (C-LEGS OPTIONAL)
- CABLE MANAGEMENT ALONG BACK

C. MOBILE PEDESTAL w/ CUSHION TOP

- 18"-24" D (450mm x 610 mm D)
- BOX/FILE DRAWERS c/w DIVIDERS, LEGAL/LETTER FILE HANGING BARS, PENCIL TRAY

D. STORAGE TOWER

- 12" W x 24" D x 54"+/- H (305 mm W x 610 mm D x 1372 mm +/- H)
- COAT ROD INCLUDED
- ANTI-TIP
- SIMILAR OVERALL HEIGHT AS STACKED PANEL

E. LOW FILE STORAGE (OPTIONAL)

- 36" W x 18" D x 27"± H (914 mm W x 457 mm D x 686 mm ± H)
- 2 DRAWER LATERAL c/w DIVIDERS, LEGAL/LETTER FILE HANGING BARS
- FLUSH BACK AND FINISHED TOP
- ANTI-TIP

F. OPEN SHELF (OPTIONAL)

- 60" W (1524 mm W)
- UNDERMOUNT TASK LIGHT (OPTIONAL)

G. LOW OPEN STORAGE (OPTIONAL)

- 36" W x 18" D x 27"± H (914 mm W x 457 mm D x 686 mm ± H)
- ONE SHELF
- FLUSH BACK AND FINISHED TOP

GENERAL NOTES

1. REFER TO LEGEND SHEET A, AND SECTION 3 OF THE TECHNICAL DESIGN REQUIREMENTS.
2. TYPICAL PANEL THICKNESS IS 3"± (76 mm ±) AS PER MANUFACTURER'S STANDARD.
3. AS COMMON PANELS ARE SHARED WHEN THEY ARE GANGED TOGETHER, THE AREA FOR AN INDIVIDUAL WORKSPACE IS BASED ON THE CENTRELINE OF THE PANEL.
4. WORKSURFACES AND STORAGE SHALL HAVE DIMENSIONAL LOGIC AND CONSISTENCY.
5. ALL WORKSURFACES TO BE FREE-STANDING (NON-PANEL HUNG).
6. ALL STORAGE TO BE LOCKABLE AND KEYED ALIKE.
7. COMPONENTS LISTED AS OPTIONAL CAN BE MIXED AND MATCHED, OR OMITTED.
8. CHAIRS ARE SHOWN FOR ILLUSTRATION ONLY.



CONSULTANT	
DOCUMENT CODE	WORKSPACE FURNITURE TYPICALS_APPENDIX I_2022-TDR.V7

PROJECT	TECHNICAL DESIGN REQUIREMENTS VERSION 7
TITLE	TYPICAL WORKSPACE- DIRECTOR (& EQUIVALENT)

DRAWN BY	JH	CHECKED BY	LJ	SCALE	NTS
DATE	2022-08-02	SITE ID	-	BUILDING ID	-
PLAN NO.	-	PHASE	-	DISCIPLINE	-
PROJECT ID.	Appendix I	SHEET NO.	4		

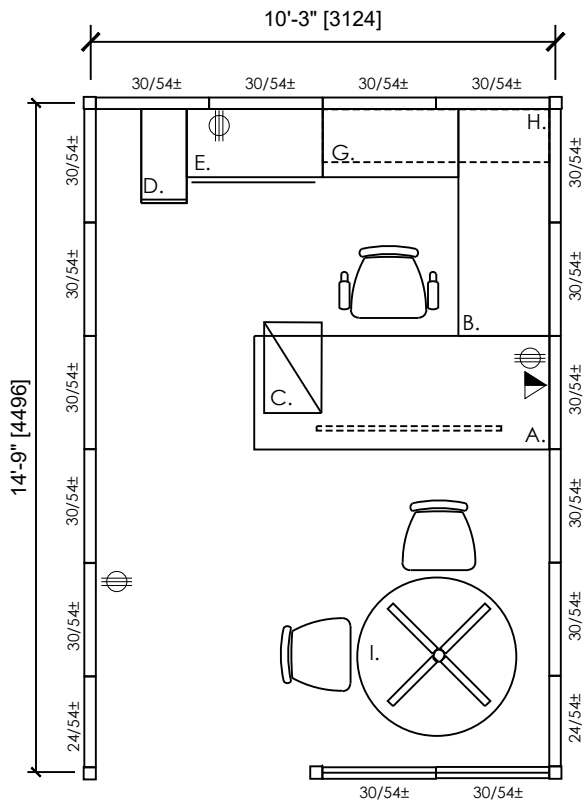

WORKSPACE KIT-OF-PARTS LEGEND:

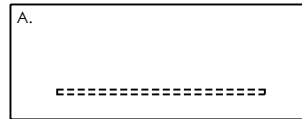

- A. PRIMARY WORKSURFACE**
- 30" D x 78" W (762 mm D x 1982 mm W)
 - ELECTRIC OR PNEUMATIC HEIGHT ADJUSTABLE
 - HALF HEIGHT MODESTY PANEL
 - CABLE MANAGEMENT ALONG SIDE



- B. SECONDARY WORKSURFACE**
- 24" D x 60" W (610 mm D x 1524 mm W)
 - PIN HEIGHT ADJUSTABLE POST LEGS (C-LEGS OPTIONAL)
 - CABLE MANAGEMENT ALONG BACK

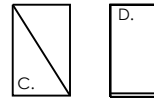

- C. MOBILE PEDESTAL w/ CUSHION TOP**
- 18"-24" D (450mm x 610 mm D)
 - BOX/FILE DRAWERS c/w DIVIDERS, LEGAL/LETTER FILE HANGING BARS, PENCIL TRAY

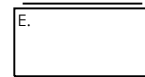

- D. STORAGE TOWER**
- 12" W x 24" D x 54"± H (305 mm W x 610 mm D x 1372 mm ± H)
 - COAT ROD INCLUDED
 - ANTI-TIP
 - SIMILAR OVERALL HEIGHT AS STACKED PANEL

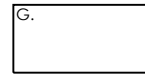

- E. LOW FILE STORAGE (OPTIONAL)**
- 36" W x 18" D x 27"± H (914 mm W x 457 mm D x 686 mm ± H)
 - 2 DRAWER LATERAL c/w DIVIDERS, LEGAL/LETTER FILE HANGING BARS
 - FLUSH BACK AND FINISHED TOP
 - ANTI-TIP

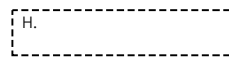

- G. LOW OPEN STORAGE (OPTIONAL)**
- 36" W x 18" D x 27" ±H (914 mm W x 457 mm D x 686 mm ± H)
 - ONE SHELF
 - FLUSH BACK AND FINISHED TOP
- H. PANEL MOUNTED CLOSED OVERHEAD (OPTIONAL)**
- 60" W x 14"± D (1524 mm W x 356 mm ± D)
 - C/W TASK LIGHT
- I. DESK HEIGHT TABLE**
- 42" Dia. (1067 mm Dia.)
 - METAL "X" BASE

GENERAL NOTES

1. REFER TO LEGEND SHEET A, AND SECTION 3 OF THE TECHNICAL DESIGN REQUIREMENTS.
2. TYPICAL PANEL THICKNESS IS 3"± (76 mm ±) AS PER MANUFACTURER'S STANDARD.
3. AS COMMON PANELS ARE SHARED WHEN THEY ARE GANGED TOGETHER, THE AREA FOR AN INDIVIDUAL WORKSPACE IS BASED ON THE CENTRELINE OF THE PANEL.
4. WORKSURFACES AND STORAGE SHALL HAVE DIMENSIONAL LOGIC AND CONSISTENCY.
5. ALL WORKSURFACES TO BE FREE-STANDING (NON-PANEL HUNG).
6. ALL STORAGE TO BE LOCKABLE AND KEYPED ALIKE.
7. COMPONENTS LISTED AS OPTIONAL CAN BE MIXED AND MATCHED, OR OMITTED.
8. THE EXECUTIVE DIRECTOR (AND EQUIVALENT) WORKSPACE IS EITHER AN OPEN WORKSTATION OPTION OR AN ENCLOSED OPTION.
9. CHAIRS ARE SHOWN FOR ILLUSTRATION ONLY.

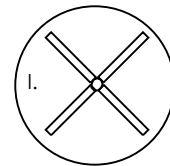

MOBILE BOX, FILE PEDESTAL w/ CUSHION TOP:

CUSHION TOP: GRADE 2/B FABRIC
 BODY: STANDARD PAINTED METAL FINISH
 STANDARD PULLS (ADA COMPLIANT)

STORAGE TOWER:

LAMINATE OR STANDARD PAINTED METAL FINISH, STANDARD PULL (ADA COMPLIANT)

LOW STORAGE:

LAMINATE OR STANDARD PAINTED METAL FINISH
 STANDARD PULL (ADA COMPLIANT)

5A EXECUTIVE DIRECTOR AND EQUIVALENT OPEN WORKSPACE OPTION
 14.0 m²

WORKSTATION FINISHES:

WORKSURFACE TOPS: H.P. PLASTIC LAMINATE C/W STANDARD MATCHING EDGE
 LAMINATE: STANDARD GRADE (INCLUDES WOOD GRAIN LAMINATE OPTIONS)
 LEGS/BASE: STANDARD PAINTED METAL FINISH (INCLUDES METALLIC OPTIONS)

PANEL FINISHES:

CLEAR OR FROSTED SINGLE PANE GLASS - FRAMELESS (ACRYLIC IS NOT ACCEPTABLE)
 PANEL FABRIC: GRADE 2/B FABRIC
 END, TOP, & CORNER TRIMS: FULL-LENGTH, STANDARD PAINTED METAL FINISH (INCLUDES METALLIC OPTIONS)



CONSULTANT	
DOCUMENT CODE	WORKSPACE FURNITURE TYPICALS_APPENDIX I_2022-TDR.V7

PROJECT	TECHNICAL DESIGN REQUIREMENTS VERSION 7
TITLE	TYPICAL WORKSPACE- OPEN OPTION EXECUTIVE DIRECTOR (& EQUIVALENT)

DRAWN BY	JH	CHECKED BY	LJ	SCALE	NTS
DATE	2022-08-02	SITE ID	-	BUILDING ID	-
PLAN NO.	-	PHASE	-	DISCIPLINE	-
PROJECT ID.	Appendix I	SHEET NO.	5A		

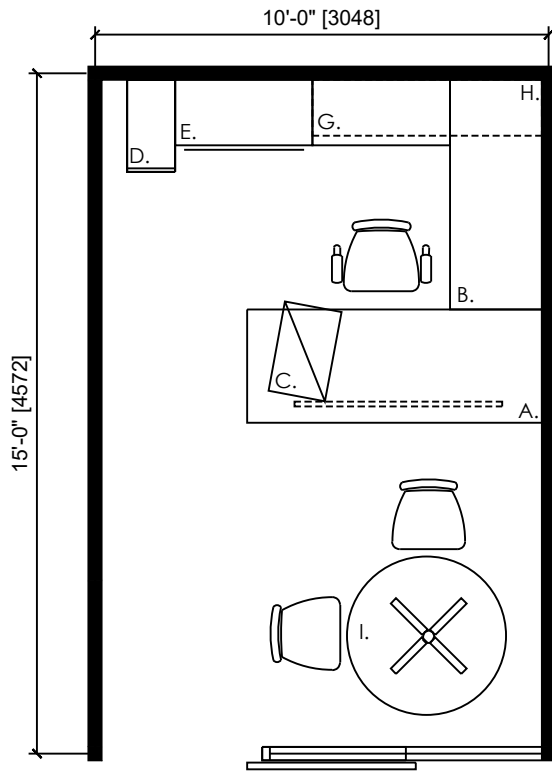

WORKSPACE KIT-OF-PARTS LEGEND:



- A. PRIMARY WORKSURFACE**
- 30" D x 78" W (762 mm D x 1982 mm W)
 - ELECTRIC OR PNEUMATIC HEIGHT ADJUSTABLE
 - HALF HEIGHT MODESTY PANEL
 - CABLE MANAGEMENT ALONG SIDE

- 36" W x 18" D x 27" ± H (914 mm W x 457 mm D x 686 mm ± H)
- ONE SHELF
- FLUSH BACK AND FINISHED TOP



- B. SECONDARY WORKSURFACE**
- 24" D x 60" W (610 mm D x 1524 mm W)
 - PIN HEIGHT ADJUSTABLE POST LEGS (C-LEGS OPTIONAL)
 - CABLE MANAGEMENT ALONG BACK

- H. CLOSED OVERHEAD WALL-MOUNTED BIN (OPTIONAL)**
- 60" W x 14" ± D (1524 mm W x 356 mm ± D)
 - C/W TACKBOARD AND TASK LIGHT

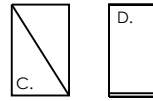

- C. MOBILE PEDESTAL w/ CUSHION TOP**
- 18"-24" D (450mm x 610 mm D)
 - BOX/FILE DRAWERS c/w DIVIDERS, LEGAL/LETTER FILE HANGING BARS, PENCIL TRAY

- I. DESK HEIGHT TABLE**
- 42" Dia. (1067 mm Dia.)
 - METAL "X" BASE



- D. STORAGE TOWER**
- 12" W x 24" D x 54" ± H (305 mm W x 610 mm D x 1372 mm ± H)
 - COAT ROD INCLUDED
 - ANTI-TIP

GENERAL NOTES

1. REFER TO LEGEND SHEET A, AND SECTION 3 OF THE TECHNICAL DESIGN REQUIREMENTS.
2. WORKSURFACES AND STORAGE SHALL HAVE DIMENSIONAL LOGIC AND CONSISTENCY.
3. WORKSPACE IS MEASURED FROM CENTRELINE OF WALL TO CENTRELINE OF WALL.
4. ALL WORKSURFACES TO BE FREE-STANDING (NON-PANEL HUNG).
5. ALL STORAGE TO BE LOCKABLE AND KEYPED ALIKE.
6. COMPONENTS LISTED AS OPTIONAL CAN BE MIXED AND MATCHED, OR OMITTED.
7. THE EXECUTIVE DIRECTOR (AND EQUIVALENT) WORKSPACE IS EITHER AN OPEN WORKSTATION OPTION OR AN ENCLOSED OPTION.
8. CHAIRS ARE SHOWN FOR ILLUSTRATION ONLY.
9. THE OVERALL LENGTH AND WIDTH OF THE ENCLOSED OFFICES MAY VARY TO SUIT SITE CONDITIONS, SO LONG AS THE SPACE REMAINS USEABLE, AND THE SIZE (SQ.M) IS MAINTAINED.



- E. LOW FILE STORAGE (OPTIONAL)**
- 36" W x 18" D x 27" ± H (914 mm W x 457 mm D x 686 mm ± H)
 - 2 DRAWER LATERAL c/w DIVIDERS, LEGAL/LETTER FILE HANGING BARS
 - FLUSH BACK AND FINISHED TOP
 - ANTI-TIP

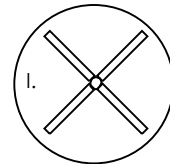

- G. LOW OPEN STORAGE (OPTIONAL)**

5B EXECUTIVE DIRECTOR (AND EQUIVALENT) ENCLOSED OFFICE OPTION
14.0 m²

WORKSTATION FINISHES:

WORKSURFACE TOPS AND TABLE: H.P. PLASTIC LAMINATE C/W STANDARD MATCHING EDGE

LAMINATE: STANDARD GRADE (INCLUDES WOOD GRAIN LAMINATE OPTIONS)

LEGS/BASE: STANDARD PAINTED METAL FINISH (INCLUDES METALLIC OPTIONS)

MOBILE BOX, FILE PEDESTAL w/ CUSHION TOP: GRADE 2/B FABRIC

BODY: STANDARD PAINTED METAL FINISH
STANDARD PULLS (ADA COMPLIANT)

STORAGE TOWER:

LAMINATE OR STANDARD PAINTED METAL FINISH
STANDARD PULLS (ADA COMPLIANT)

LOW STORAGE:

LAMINATE OR STANDARD PAINTED METAL FINISH
STANDARD PULL - METAL FINISH (ADA COMPLIANT)

CLOSED OVERHEAD:

LAMINATE OR STANDARD PAINTED METAL FINISH

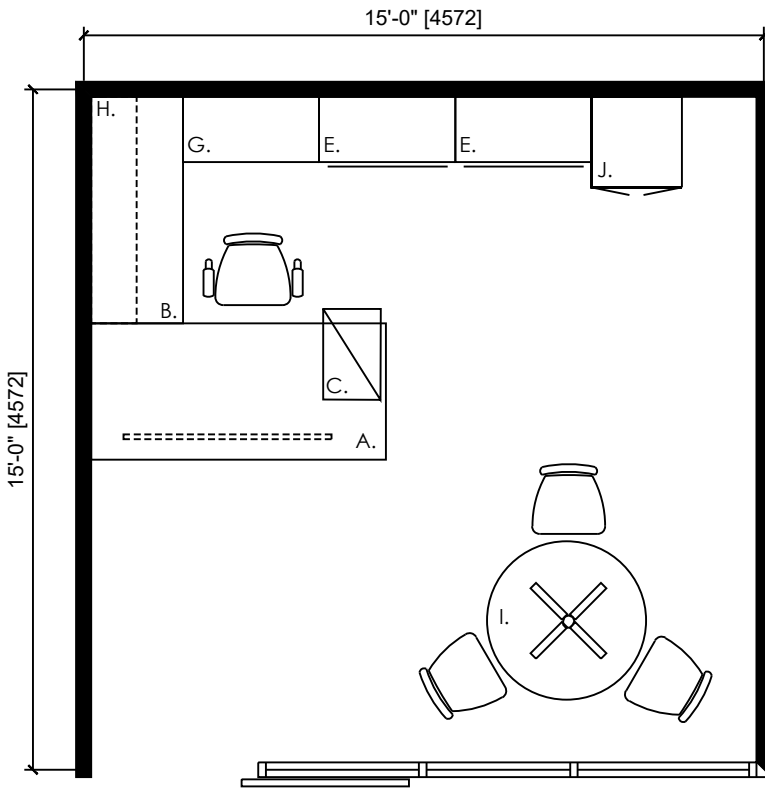

6 ASSISTANT DEPUTY MINISTER (AND EQUIVALENT) OFFICE
20.9 m²

FINISHES:

- WOOD VENEER TOP AND BODY (STANDARD GRADE)
- SQUARE PROFILE EDGE
- FLUSH BACKS AND FINISHED TOPS
- STANDARD METAL PULLS (ADA COMPLIANT)
- TACKBOARD FABRIC: MID-GRADE

WORKSPACE KIT-OF-PARTS LEGEND:

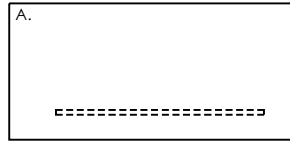

- A. PRIMARY WORKSURFACE**
- 36" D x 78" W (914 mm D x 1982 mm W)
 - ELECTRIC OR PNEUMATIC HEIGHT ADJUSTABLE
 - HALF HEIGHT MODESTY PANEL
 - CABLE MANAGEMENT ALONG SIDE

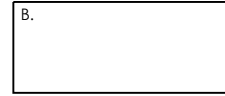

- B. SECONDARY WORKSURFACE**
- 24" D x 60" W (610 mm D x 1524 mm W)
 - PIN HEIGHT ADJUSTABLE POST LEGS (C-LEGS OPTIONAL)
 - CABLE MANAGEMENT ALONG BACK



- C. MOBILE PEDESTAL (FINISHED TOP, NO CUSHION)**

- 18"-24" D (450mm x 610 mm D)
- BOX/FILE DRAWERS c/w DIVIDERS, LEGAL/LETTER FILE HANGING BARS, PENCIL TRAY



- E. LOW FILE STORAGE (OPTIONAL)**

- 36" W x 18" D x 27" ± H (914 mm W x 457 mm D x 686 mm ± H)
- 2 DRAWER LATERAL c/w DIVIDERS, LEGAL/LETTER FILE HANGING BARS
- FLUSH BACK AND FINISHED TOP
- ANTI-TIP

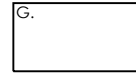

- G. LOW OPEN STORAGE (OPTIONAL)**

- 36" W x 18" D x 27" ± H (914 mm W x 457 mm D x 686 mm ± H)
- ONE SHELF
- FLUSH BACK AND FINISHED TOP



- H. CLOSED OVERHEAD WALL-MOUNTED BIN (OPTIONAL)**

- 60" W x 14" ± D (1524 mm W x 356 mm ± D)
- C/W TACKBOARD AND TASK LIGHT

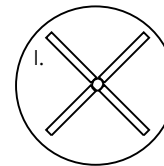

- I. LOW OPEN STORAGE (OPTIONAL)**

- 36" W x 18" D x 27" ± H (914 mm W x 457 mm D x 686 mm ± H)
- ONE SHELF
- FLUSH BACK AND FINISHED TOP

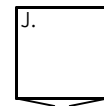

- J. CLOSED COMBINATION WARDROBE AND STORAGE CABINET**
- 24" D x 24" W (610 mm D x 610 mm W)
 - ANTI-TIP

GENERAL NOTES

1. REFER TO LEGEND SHEET A, AND SECTION 3 OF THE TECHNICAL DESIGN REQUIREMENTS.
2. WORKSPACE IS MEASURED FROM CENTRELINE OF WALL TO CENTRELINE OF WALL.
3. WORKSURFACES AND STORAGE SHALL HAVE DIMENSIONAL LOGIC AND CONSISTENCY.
4. ALL WORKSURFACES TO BE FREE-STANDING (NON-PANEL HUNG).
5. ALL STORAGE TO BE LOCKABLE AND KEYED ALIKE.
6. COMPONENTS LISTED AS OPTIONAL CAN BE MIXED AND MATCHED, OR OMITTED.
7. CHAIRS ARE SHOWN FOR ILLUSTRATION ONLY.
8. THE OVERALL LENGTH AND WIDTH OF THE ENCLOSED OFFICES MAY VARY TO SUIT SITE CONDITIONS, SO LONG AS THE SPACE REMAINS USEABLE, AND THE SIZE (SQ.M) IS MAINTAINED.

	CONSULTANT	PROJECT	DRAWN BY	CHECKED BY	SCALE
		TECHNICAL DESIGN REQUIREMENTS VERSION 7	JH	LJ	NTS
	DOCUMENT CODE WORKSPACE FURNITURE TYPICALS_APPENDIX I_2022-TDR.V7	TITLE	DATE	SITE ID	BUILDING ID
	ASSISTANT DEPUTY MINISTER (& EQUIVALENT)	2022-08-02	-	-	
		PLAN NO.	PHASE	DISCIPLINE	
		-	-	-	
		PROJECT ID.	SHEET NO.		
		Appendix I	6		

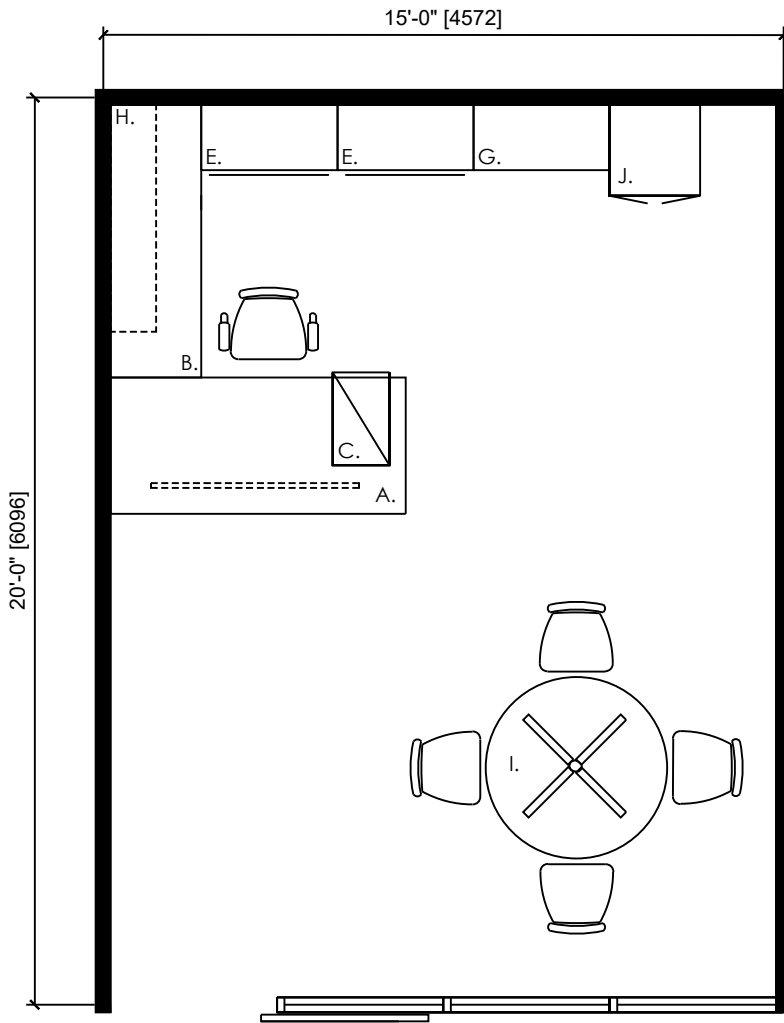

WORKSPACE KIT-OF-PARTS LEGEND:

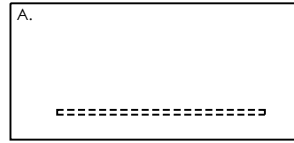

- A. PRIMARY WORKSURFACE**
- 36" D x 78" W (914 mm D x 1982 mm W)
 - ELECTRIC OR PNEUMATIC HEIGHT ADJUSTABLE
 - HALF HEIGHT MODESTY PANEL
 - CABLE MANAGEMENT ALONG SIDE

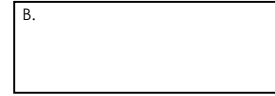

- B. SECONDARY WORKSURFACE**
- 24" D x 72" W (610 mm D x 1828 mm W)
 - PIN HEIGHT ADJUSTABLE POST LEGS (C-LEGS OPTIONAL)
 - CABLE MANAGEMENT ALONG BACK



- C. MOBILE PEDESTAL (FINISHED TOP, NO CUSHION)**
- 18"-24" D (450mm x 610 mm D)
 - BOX/FILE DRAWERS c/w DIVIDERS, LEGAL/LETTER FILE HANGING BARS, PENCIL TRAY



- E. LOW FILE STORAGE (OPTIONAL)**
- 36" W x 18" D x 27"± H (914 mm W x 457 mm D x 686 mm ± H)
 - 2 DRAWER LATERAL c/w DIVIDERS, LEGAL/LETTER FILE HANGING BARS
 - FLUSH BACK AND FINISHED TOP
 - ANTI-TIP

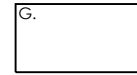

- G. LOW OPEN STORAGE (OPTIONAL)**
- 36" W x 18" D x 27"± H (914 mm W x 457 mm D x 686 mm ± H)
 - ONE SHELF
 - FLUSH BACK AND FINISHED TOP



- H. CLOSED WALL-MOUNTED OVERHEAD BIN (OPTIONAL)**
- 60" W x 14"± D (1524 mm W x 356 mm ± D)
 - C/W TACKBOARD AND TASK LIGHT

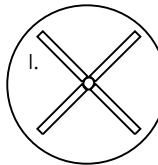

- I. DESK HEIGHT TABLE**
- 48" Dia. (1219 mm Dia.)
 - METAL TULIP BASE

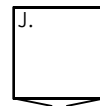

- J. CLOSED COMBINATION WARDROBE AND STORAGE CABINET**
- 24" D x 24" W (610 mm D x 610 mm W)
 - ANTI-TIP

GENERAL NOTES

1. REFER TO LEGEND SHEET A, AND SECTION 3 OF THE TECHNICAL DESIGN REQUIREMENTS.
2. WORKSPACE IS MEASURED FROM CENTRELINE OF WALL TO CENTRELINE OF WALL.
3. WORKSURFACES AND STORAGE SHALL HAVE DIMENSIONAL LOGIC AND CONSISTENCY.
4. ALL WORKSURFACES TO BE FREE-STANDING (NON-PANEL HUNG).
5. ALL STORAGE TO BE LOCKABLE AND KEYPED ALIKE.
6. COMPONENTS LISTED AS OPTIONAL CAN BE MIXED AND MATCHED, OR OMITTED.
7. CHAIRS ARE SHOWN FOR ILLUSTRATION ONLY.
9. THE OVERALL LENGTH AND WIDTH OF THE ENCLOSED OFFICES MAY VARY TO SUIT SITE CONDITIONS, SO LONG AS THE SPACE REMAINS USEABLE, AND THE SIZE (SQ.M) IS MAINTAINED.

FINISHES:

- WOOD VENEER TOP AND BODY (STANDARD GRADE)
- REVERSE CHAMFER EDGE PROFILE
- FLUSH BACKS AND FINISHED TOPS
- UPGRADED METAL PULLS, IF AVAILABLE (ADA COMPLIANT)
- TACKBOARD FABRIC: MID-GRADE

7 DEPUTY MINISTER (AND EQUIVALENT) OFFICE
27.9 m²